

Attachment B5

Selected Drawing



Figure 1: Render of proposed design

Drawing Register

Drawing No.	Drawing Title	Scale at A3	Issue No.
L00	Title Sheet	NA	F
L01	Tree Management Plan	1:1000	E
L02	Landscape General Arrangement - North	1:400	E
L03	Landscape General Arrangement - South	1:400	E
L04	Site Long Section (East-West)	1:200	C
L05	Site Long Section (North-South)	1:200	C
Lo6A-B	Materials & Finishes Schedule	N/A	C
L07	Planting Palette - Mass Planting	1:1000	D
L08	Planting Palette - Trees	1:1000	E
L09	Deep Soil and Tree Canopy Coverage	1:1000	E

Design Statement

Recognising the prominence of the heritage and importance of this gateway location to Sydney Park, the landscape design for the Brick Kilns precinct ensures an open and accessible public space, while providing an appropriate setting for heritage structures and legible interpretation of the site's history and general park use. Ecosystem services are provided in the form of on-site stormwater management and multi-strata planting. Further to this aim, five robust *Ficus rubiginosa* specimens are retained, and supplemented with new canopy feature trees, to serve as shady and consistent markers throughout the precinct. Many of the suppressed plantings affecting structural integrity, access and historic interpretation are proposed for removal.

Restoration of a uniform ground level (faithful to the original industrial setting), and a unified palette of red (brick-like) crushed granite and red brick simplifies the space around the conserved kilns, complementing the associated architectural restoration works. Aligned with the restored roof eave splash zones is brick laid in a herringbone pattern to accentuate movement of water away from the kilns while providing accessible circulation around the buildings. Demolished buildings are memorialised by brick inlay corresponding to their original layout. From this restored building complex, a series of plaza spaces emerge, suitable for small to medium organised and informal outdoor gatherings.

As a central feature of the precinct, the former Processing Plant is marked by a sloped lawn (for present-day informal relaxation) and lined by corrugated concrete and corten seating edges along its boundary. Cast iron plates, concrete plinths, original relics on display and narrow-gauge tram-tracks laid in turf all aid in heritage interpretation of the building and its uses. A feature tree (a *Eucalyptus haemastoma* with its distinctive form) set in the lawn softens and balances the industrial history of the site within the precinct's parkland character.

A path hierarchy runs through the site and links to surrounding nodes; Sydney Park's main pedestrian spine extends through the precinct to the Park's north-west entry, and a secondary path through the precinct of buildings; seating is provided in various forms and layouts (both formal to casual); and diverse recreation needs are served by pockets of flat and sloped lawn, interpretive elements highlighting natural and built cultural heritage, and the footprint of the former oil bund building - now conceived of as a low stage facing the adjacent natural lawn amphitheatre.





To mark the former industrial uses of the site, a Memory Pit Garden is created by the extent of the quarry at two points in time and reinstates endemic Sydney Turpentine Ironbark Forest (the original vegetation community prior to clearing for industrial works). Continuing Sydney Park's water sensitive urban design approach, major stormwater catchments on site are directed to subtle lawn depressions for on-site absorption, before draining to the Memory Pit Garden. A planting scheme drawing from both exotic and endemic palettes has been designed to tie into the wider park ecology. At the main north-west entrance, a colourful *Alloxylon flammeum* provides a visually-distinctive, seasonal landmark. *Eucalyptus sideroxylon* in grass areas enhance the amenity of the precinct and connect back to the broader park. Mass planting schemes have been selected to suit the microclimate of various pockets of space while deferring to the conserved kilns.

Tree Management Plan

TREE REMOVAL SCHEDULE

TREE NO.	BOTANICAL NAME	COMMON NAME	HEIGHT (m)	DESIGN JUSTIFICATION
T01	<i>Fraxinus angustifolia</i>	Claret Ash	7	Impact on structure. Located within the sunken brick ground-plane. Change to levels to improve accessibility into the site. Improved site drainage.
T02	<i>Castanospermum australe</i>	Black Bean	5	Impact on structure. Improve entry at this prominent gateway.
T03	<i>Fraxinus angustifolia</i>	Claret Ash	8	Impact on structure. Located within the sunken brick ground-plane. Change to levels to improve accessibility into the site. Improved site drainage.
T04	<i>Fraxinus angustifolia</i>	Claret Ash	11	Impact on structure. Located within the sunken brick ground-plane. Change to levels to improve accessibility into the site. Improved site drainage.
T05	<i>Fraxinus angustifolia</i>	Claret Ash	12	Impact on structure. Located within the sunken brick ground-plane. Change to levels to improve accessibility into the site. Improved site drainage.
T06	<i>Fraxinus angustifolia</i>	Claret Ash	6	Impact on structure. Located within the sunken brick ground-plane. Change to levels to improve accessibility into the site. Improved site drainage.
T07	<i>Fraxinus angustifolia</i>	Claret Ash	5	Located within the sunken brick ground-plane. Change to levels to improve accessibility through the site.
T08	<i>Fraxinus angustifolia</i>	Claret Ash	5	Change to levels to improve accessibility through the site.
T09	<i>Fraxinus angustifolia</i>	Claret Ash	8	Change to levels to improve accessibility through the site.
T10	<i>Fraxinus angustifolia</i>	Claret Ash	8	Impact on structure. Conflict with proposed stabilisation of building - new roof. Change to levels to improve accessibility through the site.
T11	<i>Fraxinus angustifolia</i>	Claret Ash	9	Impact on structure. Conflict with proposed stabilisation of building - new roof. Change to levels to improve accessibility through the site.
T12	<i>Fraxinus angustifolia</i>	Claret Ash	9	Impact on structure. Conflict with proposed stabilisation of building - new roof. Change to levels to improve accessibility through the site.
T13	<i>Fraxinus angustifolia</i>	Claret Ash	9	Impact on structure. Conflict with proposed stabilisation of building - new roof. Change to levels to improve accessibility through the site.
T14	<i>Fraxinus angustifolia</i>	Claret Ash	8	Impact on structure. Conflict with proposed stabilisation of building - new roof. Change to levels to improve accessibility through the site.
T15	<i>Fraxinus angustifolia</i>	Claret Ash	9	Impact on structure. Located within the sunken brick ground-plane. Change to levels to improve accessibility through the site.
T18	<i>Ficus rubiginosa</i>	Port Jackson Fig	6	Heritage interpretation of the former brickworks buildings and structures (building footprint). Change to levels to improve stormwater drainage on site.
T19	<i>Ficus rubiginosa</i>	Port Jackson Fig	6	Heritage interpretation of the former brickworks buildings and structures (building footprint). Change to levels to improve stormwater drainage on site.
T20	<i>Ficus rubiginosa</i>	Port Jackson Fig	6	Heritage interpretation of the former brickworks buildings and structures (building footprint). Accessible pathway through Precinct. Change to levels to improve stormwater drainage on site.
T21	<i>Ficus rubiginosa</i>	Port Jackson Fig	7	Heritage interpretation of the former brickworks buildings and structures (heritage sightlines). Change to levels to improve stormwater drainage on site. Accessible pathway through Precinct.
T23	<i>Ficus rubiginosa</i>	Port Jackson Fig	5	Condition is showing various stages of decay. Heritage interpretation of workings of the Brick Kiln Precinct (heritage sightlines).
T24	<i>Eucalyptus sideroxylon</i>	Red Ironbark	8	Impact on structure/heritage building. Heritage interpretation of the former brickworks buildings and structures (heritage sightlines).
T26	<i>Callistemon viminalis</i>	Weeping Bottlebrush	5	Heritage interpretation of the former brickworks buildings and structures (building footprint).
T27	<i>Eucalyptus haemastoma</i>	Scribbly Gum	6	Heritage interpretation of the former brickworks buildings and structures (building footprint).
T28	<i>Fraxinus angustifolia</i>	Claret Ash	4	Located within the sunken brick ground-plane. Change to levels to improve accessibility through the site. Heritage interpretation of the former brickworks buildings and structures (heritage sightlines).
T29	<i>Ficus rubiginosa</i>	Port Jackson Fig	5	Condition is showing advanced stages of decay. Heritage interpretation of the former brickworks buildings and structures (heritage sightlines). Change to levels to improve stormwater drainage on site.

LEGEND

-  Extent of works
-  Existing trees to be retained and protected - Refer Arborist Tree Assessment Report (Tree IQ 16/12/21 Rev A)
-  Existing tree Structural Root Zone and Tree Protection Zone
-  Existing trees to be removed
-  Existing multistemmed shrubs (*Callistemon viminalis*) to be retained



General Arrangement - North



- LEGEND**
- Extent of works
 - - - Lot boundary
 - Sydney Metro tunnel asset (below)
 - ⊕ Existing trees to be retained
 - ⊖ Existing trees to be removed
 - ⊕ Proposed trees
 - Mass planting
 - Turf
 - Roof line (over)
 - Swale flow path - centreline
 - WM: Existing water meter to be retained
 - - - Contours - existing (100mm interval)
 - Contours- proposed (100mm interval)
- Paving**
- DE: Stabilised decomposed granite gravel
 - BP: Brick paving
 - BP1: Brick paving interpreting previous buildings
 - BP2: Brick paving interpreting chimney flues
 - CO: Concrete path to match existing
 - SH: Crushed shale mulch
 - AS: Asphalt path to match existing
- Edges**
- BE: Brick edging
 - CE: Concrete edging wall interpreting previous Process. Plant
 - ST: Steel Edge
- Seating & Walls**
- BW: Brick seating wall interpreting previous Kiln interior
 - RW: Brick retaining wall
 - SB: Timber seat, bench or chair
 - SB*: Accessible timber seat or chair (DDA)
 - SW: Brick and concrete seating wall
- Furniture & Fixtures**
- DF: Drinking fountain
 - LP: Light pole
- Drainage**
- GR: Trench Drain Grate
 - SW: Riprap Swale - Maximum 800mm width within TPZ
- Electrical**
- E-P: Ausgrid pillar
 - E-SB: Electrical switchboard & elements
 - PB: Power Bollard

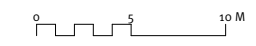

Revisions

Issue	Date	Description	Drawn	Check
D	10/07/2023	DA Update	SO	AJ
E	14/12/2023	DA UPDATE	HL	CB

General Arrangement - South



- LEGEND**
- Extent of works
 - - - Lot boundary
 - Sydney Metro tunnel asset (below)
 - Existing trees to be retained
 - Existing trees to be removed
 - Proposed trees
 - Mass planting
 - Turf
 - Roof line (over)
 - Swale flow path - centreline
 - WM: Existing water meter to be retained
 - Contours - existing (100mm interval)
 - Contours - proposed (100mm interval)
- Paving**
- DE: Stabilised decomposed granite gravel
 - BP: Brick paving
 - BP1: Brick paving interpreting previous buildings
 - BP2: Brick paving interpreting chimney flues
 - CO: Concrete path to match existing
 - SH: Crushed shale mulch
 - AS: Asphalt path to match existing
- Edges**
- BE: Brick edging
 - CE: Concrete edging wall interpreting previous Process. Plant
 - ME1: Metal edging - corten with cutout lettering
 - ME2: Metal edging interpreting previous tram-line
 - ST: Steel Edge
- Seating & Walls**
- BW: Brick seating wall interpreting previous Kiln interior
 - RW: Brick retaining wall
 - SB: Timber seat, bench or chair
 - SB*: Accessible timber seat or chair (DDA)
 - SW: Brick and concrete seating wall
- Furniture & Fixtures**
- CP: Concrete plinths - interpreting previous Processing Plant
 - DF: Drinking fountain
 - LP: Light pole
- Drainage**
- GR: Trench Drain Grate
 - SW: Riprap Swale - Maximum 800mm width within TPZ

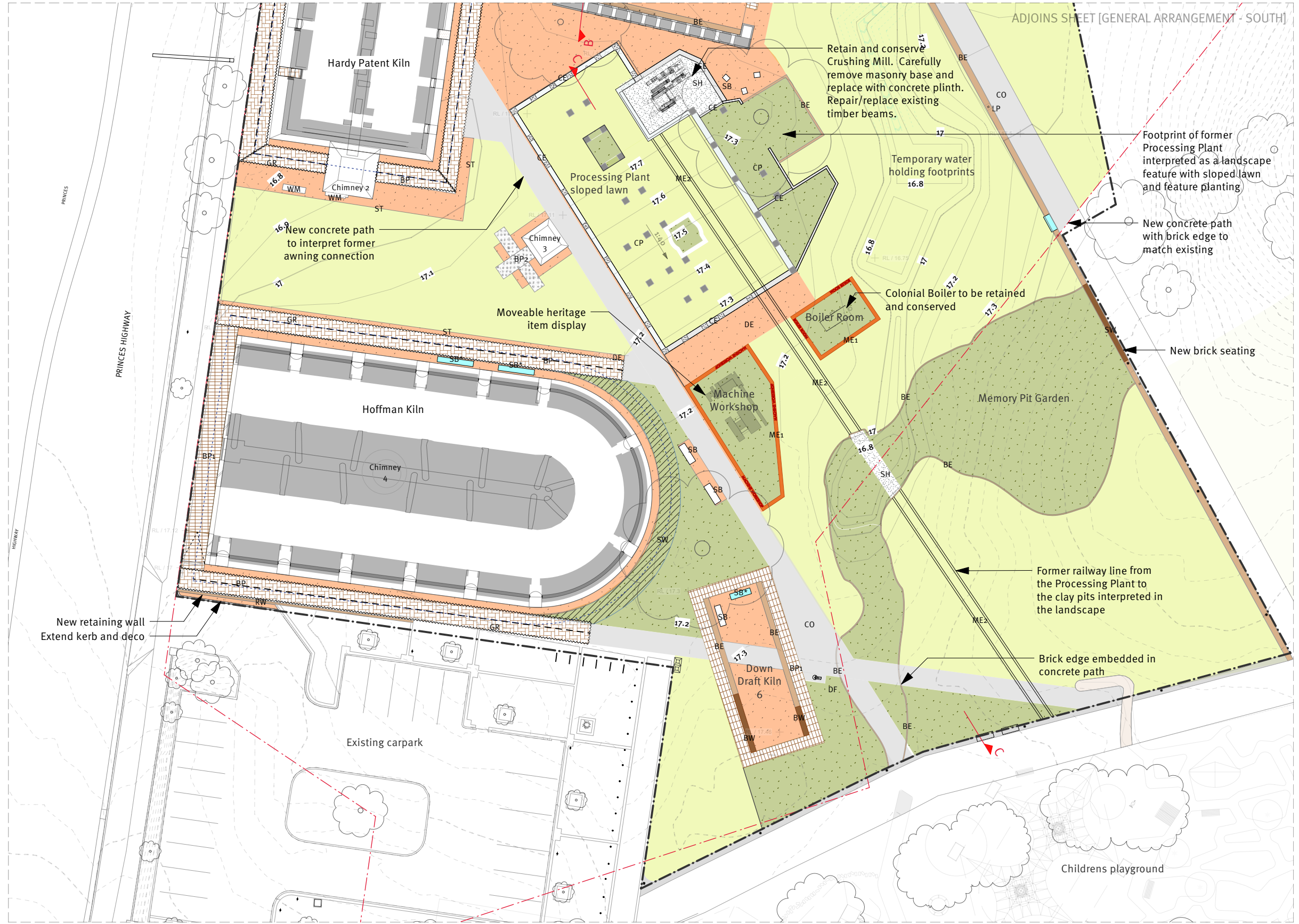

Section AA



119



Footpath Entry Plaza Primary Path Oil Bund Stage Grass swale Amphitheatre lawn

1 AA
Scale: 1:200

Client
CITY OF SYDNEY

Consultant
tonkinzulaikha greer ARCHITECTS

Revisions		Issue	Date	Description	Drawn	Check
B	28/04/2023	For DA	SO	AJ		
C	12/05/2023	For DA	SO	AJ		

JMD design

190 James Street
Redfern NSW 2016
T (02) 9310 5644
info@jmdesign.com.au

Project
Sydney Park Brick Kilns
Drawing Title
Section AA

Date
May 2023
Scale
AS NOTED @ A3

Drawing No.	Issue No.
LO4	C

Section BB & CC

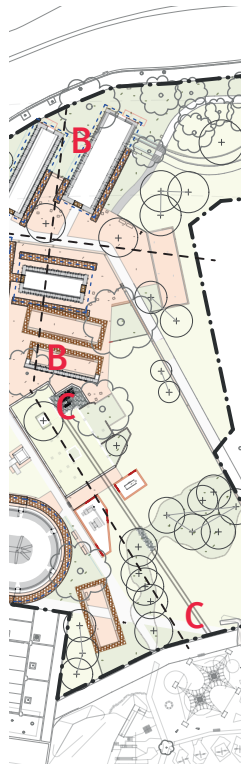

'Ruins' in Lush Valley Planting

Path from Entry Plaza

Down Draft Kilns

1 BB
Scale: 1:200

120



Processing Plant Sloped Lawn

Machine Workshop

Memory Pit Garden

Concrete path

2 CC
Scale: 1:200

Client
CITY OF SYDNEY

Consultant
tonkinzulaikha greer ARCHITECTS

Revisions		Issue	Date	Description	Drawn	Check
B	28/04/2023	For DA	SO	AJ		
C	12/05/2023	For DA	SO	AJ		

JMD design



190 James Street
Redfern NSW 2016
T (02) 9310 5644
info@jmdesign.com.au

Project
Sydney Park Brick Kilns
Drawing Title
Section BB & CC

Date
May 2023
Scale
AS NOTED @ A3

Drawing No. Issue No.
L05 C

Paving



DE: Stabilised decomposed granite gravel

BP: Brick paving

CO: Concrete path to match existing

BE: Brick edge

SH: Crushed shale mulch

AS: Asphalt path to match existing

Heritage interpretation



CP: Concrete plinths interpreting previous Processing Plant

BP1: Brick paving interpreting previous buildings

BP2: Brick paving interpreting chimney flues



CE: Concrete edging wall interpreting previous Process Plant

CE: Concrete edging interpreting previous Process Plant

ME1: Metal edging - corten with cutout lettering - interpreting previous ancillary building

ME2: Metal edging interpreting previous tram-line

Seating & Walls



SW: Brick and concrete seating wall



RW: Brick retaining wall



SB: Timber seat - DDA (SFA)



SB: Timber bench (SFA)



SB: Timber seat - DDA (Emerdyn)



SB: Timber chair - DDA (Emerdyn)

Furniture & Fixtures



LP: Light pole



DF: Drinking Fountain

Drainage



GR: Special grates in cast iron finish

Indicative Mass Planting Palette



A: Brick Kiln Apron Grassland

INDICATIVE SHRUBS & GROUNDCOVERS	
<i>Austrodanthonia tenuior</i>	Purplish Wallaby Grass
<i>Cissus antarctica</i>	Kangaroo Vine
<i>Dianella caerulea</i>	Paroo Lily, Blue Flax-lily
<i>Dichelachne micrantha</i>	Shonhair Plumegrass
<i>Echinopogon ovatus</i>	Forest Hedgehog Grass
<i>Eragrostis brownii</i>	Browns Lovegrass
<i>Ficinia nodosa</i>	Knobby club-rush
<i>Poa labillardieri</i>	Common Tussock Grass
<i>Pollia crispata</i>	Pollia crispata
<i>Themeda australis</i>	Kangaroo Grass



B: Fig-tree Understorey Groundcover

INDICATIVE GROUNDCOVERS	
<i>Blechnum cartilagineum</i>	Gristle Fern, Water Fern
<i>Cissus antarctica</i>	Kangaroo Vine
<i>Dianella caerulea</i>	Paroo Lily, Blue Flax-lily
<i>Doodia aspera</i>	Prickly Rasp Fern
<i>Ficinia nodosa</i>	Knobby club-rush
<i>Pollia crispata</i>	Pollia crispata



D: 'Ruins' in Lush Valley

INDICATIVE SHRUBS	
<i>Cyathea cooperi</i>	Lacy Tree Fern
<i>Crinum pedunculatum</i>	Swamp Lily

SCRAMBLERS & GROUNDCOVERS	
<i>Arthropodium cirratum</i>	Renga Lily
<i>Blechnum cartilagineum</i>	Gristle Fern, Water Fern
<i>Bulbine bulbosa</i>	Bulbine Lily, Wild Onion, Golden lily
<i>Doodia aspera</i>	Prickly Rasp Fern
<i>Pollia crispata</i>	Pollia crispata
<i>Pteridium esculentum</i>	Austral Bracken



E1: Memory Pit Garden (Sydney Turpentine Ironbark Forest) - Sloped

INDICATIVE SHRUBS & SCRAMBLERS	
<i>Acacia floribunda</i>	*White Sally Wattle, Sally, Marral-uo, Gossamer Wattle*
<i>Breytia oblongifolia</i>	*Coffee Bush, Oblong-leaved Breytia*
<i>Clerodendron tomentosum</i>	downy chance, hairy lolly bush
<i>Indigofera australis</i>	Australian Indigo
<i>Ozothamnus diosmifolius</i>	*Rice Flower, White Dogwood, Pill Flower, Sago Bush*

GRASSES	
<i>Dichelachne micrantha</i>	Shonhair Plumegrass
<i>Echinopogon ovatus</i>	Forest Hedgehog Grass



E2: Memory Pit Garden (Sydney Turpentine Ironbark Forest) - Wet Plantings

INDICATIVE SMALL TREES	
<i>Elaeocarpus reticulatus</i>	Blueberry Ash
<i>Pittosporum undulatum</i>	Sweet pittosporum, Native Daphne

GROUNDCOVERS & GRASSES	
<i>Carex appressa</i>	Tall Sedge
<i>Commelina cyanea</i>	Wandering Jew
<i>Crinum pedunculatum</i>	Swamp Lily, River Lily
<i>Dianella caerulea</i>	Paroo Lily, Blue Flax-lily
<i>Ficinia nodosa</i>	Knobby club-rush
<i>Gahnia aspera</i>	Rough Saw-sedge

- Extent of works
- ⊗ Existing trees to be retained
- ⊕ Proposed trees
- Light Green Turf - Proposed/Make good
- Dark Green Turf - Existing
- Diagonal Hatching Proposed Mass Planting - Refer Species Lists and hatches above



0 10 20 M

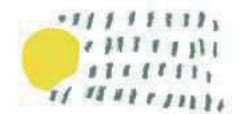

Indicative Tree Planting

SPECIES LIST

ID	QTY	BOTANICAL NAME	COMMON NAME	Nom. Dia 20 yrs (m)
Af	2	<i>Alloxylon flammeum</i>	Tree Waratah	4
Ee	1	<i>Eucalyptus eugenioides</i>	Thin-leaved Stringybark	11
Eh	3	<i>Eucalyptus haemastoma</i>	Scribbly Gum	7
Epa	3	<i>Eucalyptus paniculata</i>	Grey Ironbark	11
Epu	1	<i>Eucalyptus punctata</i>	Grey Gum	7
Esa	2	<i>Eucalyptus saligna</i>	Sydney Blue Gum	11
Esi	5	<i>Eucalyptus sideroxylon</i>	Red Ironbark	11
Sg	9	<i>Syncarpia glomulifera</i>	Turpentine	11

Ee: *Eucalyptus eugenioides* Epa: *Eucalyptus paniculata* Epu: *Eucalyptus punctata*



Esa: *Eucalyptus saligna* Sg: *Syncarpia glomulifera* Ficus rubiginosa



Af: *Alloxylon flammeum* Esi: *Eucalyptus sideroxylon* Eh: *Eucalyptus haemastoma*



- LEGEND**
- Extent of works
 - ☉ Existing trees to be retained
 - 🌳 Trees proposed
 - 🚫 Trees removed



Deep Soil and Canopy calcs.

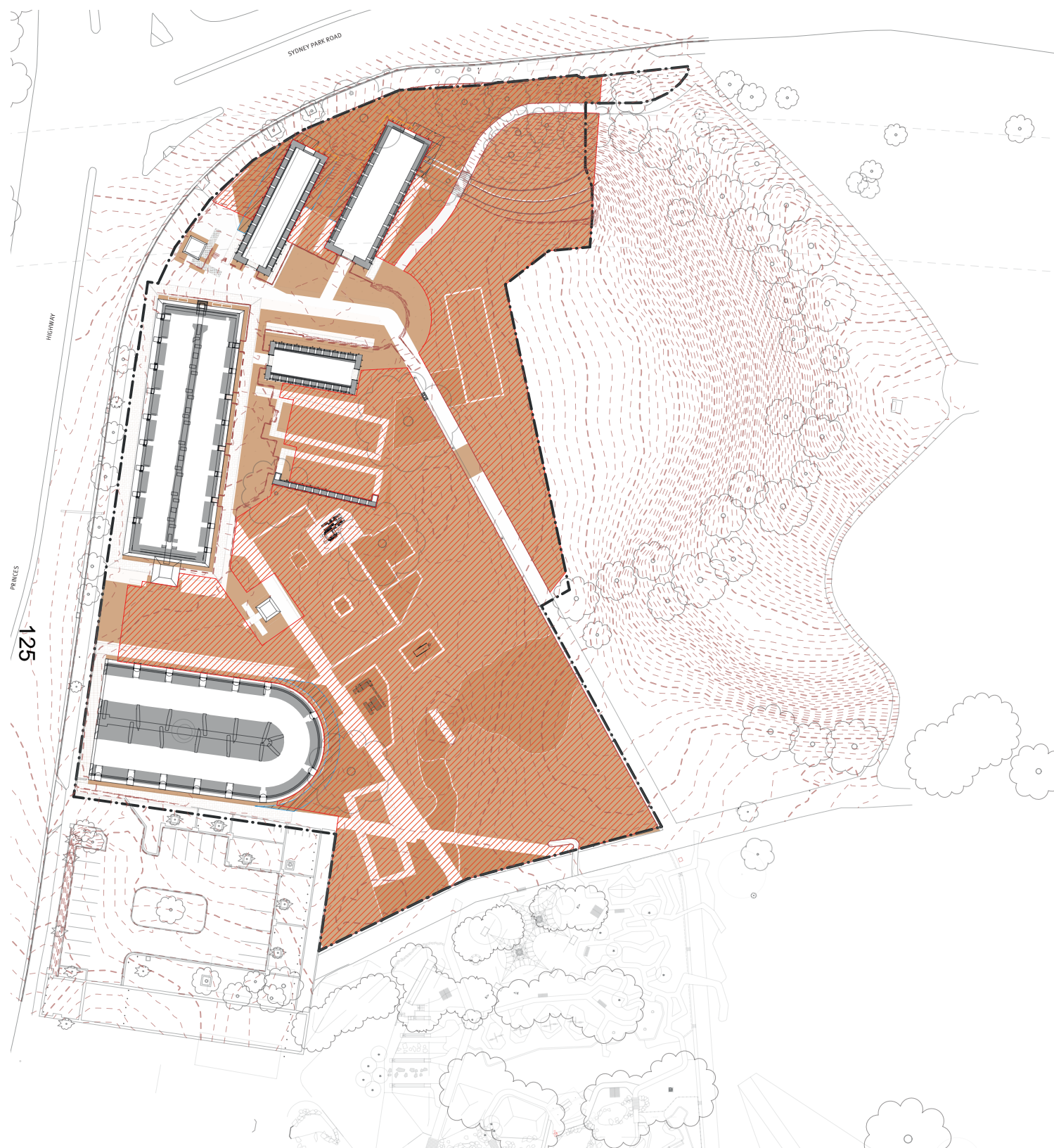

LEGEND
 Deep Soil Area - Existing (7,198 sqm; 62% of site area)
 Deep Soil Area - Proposed (6,737 sqm; 58% of site area)
 Contours (100mm interval) - Existing

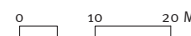

LEGEND
 Existing tree to be retained - with TPZ and SRZ (13 ; 1,516 sqm ; 13% of site area)
 Existing tree to be removed (25 ; 1,524 sqm ; 13% of site area)
 Proposed tree (26 ; 2,078 sqm ; 18% of site area)
 Dense groundcover planting - Existing - to be removed (85 sqm ; 1% of site area)
 Dense groundcover planting - Proposed (1,638 sqm ; 15% of site area)

Note:
 Total site area: 11,575 sqm
 Tree site area: 11,575 sqm
 Tree sizes shown at 20 years maturity
 Existing tree canopy coverage: 3,282 sqm (28% of site area)
 Proposed and retained tree canopy coverage: 3,594 sqm (31% of site area)

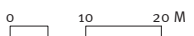

Client
 Consultant
tonkinzulaikhagreer ARCHITECTS

Revisions

Issue	Date	Description
D	13/07/2023	DA Update
E	28/08/2023	DA UPDATE

Drawn
 SO
 HL

Check
 CB
 CB

JMD design



190 James Street
 Redfern NSW 2016
 T (02) 9310 5644
 info@jmdesign.com.au

Project
 Sydney Park Brick Kilns
 Drawing Title
 Deep Soil and Canopy calcs.

Date
 July 2023
 Scale
 1:1000 @ A3



Drawing No. | Issue No.
 Log | E